

Wastecorp Turbo Flow WES Series
End Suction Centrifugal Pumps
A Wastecorp® Pump Brand



WES Series End Suction





Turbo-Flow WES Series End Suction Pumping Power

The Turbo Flow end suction WES Series Pumps utilize premium components and the latest technology for use in a wide range of industrial and public works applications. Select from either vertical or horizontal discharge mount configurations and engine or electric drives. Wastecorp. designs the Turbo Flow WES Series for a long life cycle, high efficiency, less downtime and lower maintenance costs than other pump brands. For vertical motor mounting configurations, refer to WSL Series.

This series of rugged, heavy-duty pumps are engineered for easy maintenance, as the entire rotation element is removable without disturbing piping or the pump body. The back pull-out design simplifies maintenance and allows for easy inspection. The WES Series is offered as a close-coupled model with available motors up to 75 HP (55 kW). The WES Series features an independent bearing housing and flexible coupling (FC) for units ranging from 100 HP (75 kW) to 1000 HP (745 kW).

WES SERIES	Fluid Transfer Characteristics
WES	Pure water or other liquids with similar physical characteristics (Temp. under 80°C or 176°F)
WES-H	Warm or Hot Water Pump (Temp. under 120°C or 248°F)
WES-C	Chemical Pump (Temp. under 120°C or 248°F)
WES-XPO	Explosion-Proof Oil Pump (non-corrosive) (Temp. under 120°C or 248°F)
WES-XPC	Explosion-Proof Chemical Pump (Temp. under 120°C or 248°F)

Industry	Plumbing Application(s)
General Water Supply	Circulation of cooling and heating building systems, water booster service, boiler feed, general circulation service
Agriculture/ Food/ Beverage	Irrigation, water supply, food processing, beverage processing, fertilizers
Manufacturing	Pulp and paper fan pumps, plastic and rubber, metal and steel, pharmaceutical, paper mills, air wash, marine ballast service
Fire/ Disaster Relief	Fire fighting pumps, fire protection, flood control, disaster relief, military
Utilities: Water/ Wastewater	Power generation stations, dewatering, desalination, energy recovery turbines
Chemical/ Mining	Chemical plants, refineries, petroleum distribution, coal sites, ethylene glycol pumping



Wastecorp Turbo Flow WES Series End Suction Centrifugal Pumps Overview of Performance Range Using 60 Hz Motors²

WES Series End Suction Pumps Overview of Pump Performance (Utilizing 60 Hz / 3600 RPM Motors)

WES SERIES MODEL	Pump Size ¹ (inches)	Suction & Discharge Conn. Size		Max. Capacity		Max. Head		Max. Impeller ³ OD Size		Max. Power		Max. Weight	
		DN (mm)	NPS (inch)	(m ³ /hr)	(GPM)	(m)	(ft)	(mm)	(inch)	(kW)	(HP)	(kg)	(lb)
WES-100	1 x 1 x 6	25	1	6	27	48	156	160	6	3	3	44	97
WES-125	1-1/4 x 1-1/4 x 6	32	1.25	8	34	49	161	160	6	3	3	49	108
WES-150	1-1/2 x 1-1/2 x 10	40	1.50	20	86	118	387	250	10	19	25	175	386
WES-200	2 x 2 x 12	50	2	40	174	184	605	315	12	52	70	330	728
WES-250	2-1/2 x 2-1/2 x 12	65	2.50	78	343	184	605	315	12	78	104	375	827
WES-300	3 x 3 x 14	80	3	156	687	225	737	350	14	130	174	680	1,499
WES-400	4 x 4 x 14	100	4	156	687	225	737	350	14	156	209	740	1,631
WES-500	5 x 5 x 12	125	5	230	1,014	192	628	315	12	156	209	720	1,587
WES-600	6 x 6 x 16	150	6	312	1,374	230	756	400	16	190	255	990	2,183

WES Series End Suction Pumps Overview of Pump Performance (Utilizing 60 Hz / 11750 RPM Motors)

WES SERIES MODEL	Pump Size ¹ (inch)	Suction & Discharge Conn. Size		Max. Capacity		Max. Head		Max. Impeller ³ OD Size		Max. Power		Max. Weight	
		DN (mm)	NPS (inch)	(m ³ /hr)	(GPM)	(m)	(ft)	(mm)	(inch)	(kW)	(HP)	(kg)	(lb)
WES-600	6 x 6 x 16	150	6	312	1,374	76	250	400	16	78	104	520	1,146
WES-800	8 x 8 x 20	200	8	624	2,747	122	402	500	20	228	306	1,250	2,756
WES-1000	10 x 10 x 20	250	10	792	3,487	125	411	500	20	276	371	1,250	2,756
WES-1200	12 x 12 x 20	300	12	1,080	4,755	122	402	500	20	432	579	1,685	3,715
WES-1400	14 x 14 x 20	350	14	1,440	6,340	122	402	500	20	544	730	2,650	5,842
WES-1600	16 x 16 x 12	400	16	1,560	6,868	53	172	315	12	228	306	1,740	3,836
WES-2000	20 x 20 x 12	500	20	1,740	7,661	50	163	315	12	276	371	2,070	4,564

WES Series End Suction Pumps Overview of Pump Performance (Utilizing 60 Hz / 1200 RPM Motors)

WES SERIES MODEL	Pump Size ¹ (inch)	Suction & Discharge Conn. Size		Max. Capacity		Max. Head		Max. Impeller ³ OD Size		Max. Power		Max. Weight	
		DN (mm)	NPS (inch)	(m ³ /hr)	(GPM)	(m)	(ft)	(mm)	(inch)	(kW)	(HP)	(kg)	(lb)
WES-1200	12 x 12 x 19	300	12	1,080	4,755	45	146	480	19	130	174	1,350	2,976
WES-1400	14 x 14 x 24	350	14	1,680	7,397	76	250	600	24	432	579	2,750	6,063
WES-1600	16 x 16 x 24	400	16	2,880	12,680	76	250	600	24	613	823	3,420	7,540

NOTES:

1. Please contact the factory for proper model selection for your application.
2. This is a general overview of the performance for this series of Turbo-Flow pumps.
3. Optional impeller sizes are available, including trimmed impeller sizes. Contact factory for additional information.
4. Wastecorp. Pumps reserves the right to make revisions to its products, performance, dimensions and specifications, and related information, without notice.



Wastecorp Turbo Flow WES Series End Suction Centrifugal Pumps Overview of Performance Range Using 50 Hz Motors²

WES Series End Suction Pumps Overview of Pump Performance (Utilizing 50 Hz / 2900 RPM Motors)

WES SERIES MODELS	Pump Size ¹ (mm)	Suction & Discharge Conn. Size		Max. Capacity		Max. Head		Max. Impeller OD Size ³		Max. Power		Max. Weight	
		DN (mm)	NPS (inch)	(m ³ /hr)	(GPM)	(m)	(ft)	(mm)	(inch)	(kW)	(HP)	(kg)	(lb)
WES-100	25 x 25 x 160	25	1	5	23	33	108	160	6	2	2	44	97
WES-125	32 x 32 x 160	32	1.25	7	29	34	112	160	6	2	2	49	108
WES-150	40 x 40 x 250	40	1.50	16	72	82	269	250	10	11	15	175	386
WES-200	50 x 50 x 315	50	2	33	145	128	420	315	12	30	40	330	728
WES-250	65 x 65 x 315	65	2.50	65	286	128	420	315	12	45	60	375	827
WES-300	80 x 80 x 350	80	3	130	572	156	512	350	14	75	101	680	1,499
WES-400	100 x 100 x 350	100	4	130	572	156	512	350	14	90	121	740	1,631
WES-500	125 x 125 x 315	125	5	192	845	133	436	315	12	90	121	720	1,587
WES-600	150 x 150 x 350	150	6	260	1,145	160	525	350	14	110	148	990	2,183

WES Series End Suction Pumps Overview of Pump Performance (Utilizing 50 Hz / 1480 RPM Motors)

WES SERIES MODELS	Pump Size ¹ (mm)	Suction & Discharge Conn. Size		Max. Capacity		Max. Head		Max. Impeller OD Size ³		Max. Power		Max. Weight	
		DN (mm)	NPS (inch)	(m ³ /hr)	(GPM)	(m)	(ft)	(mm)	(inch)	(kW)	(HP)	(kg)	(lb)
WES-600	150 x 150 x 400	150	6	260	1,145	53	174	400	16	45	60	520	1,146
WES-800	200 x 200 x 500	200	8	520	2,289	85	279	500	20	132	177	1,250	2,756
WES-1000	250 x 250 x 500	250	10	660	2,906	87	285	500	20	160	215	1,250	2,756
WES-1200	300 x 300 x 500	300	12	900	3,963	85	279	500	20	250	335	1,685	3,715
WES-1400	350 x 350 x 500	350	14	1,200	5,283	85	279	500	20	315	422	2,650	5,842
WES-1600	400 x 400 x 315	400	16	1,300	5,724	37	120	315	12	132	177	1,740	3,836
WES-2000	500 x 500 x 315	500	20	1,450	6,384	35	113	315	12	160	215	2,070	4,564

WES Series End Suction Pumps Overview of Pump Performance (Utilizing 50 Hz / 980 RPM Motors)

WES SERIES MODELS	Pump Size ¹ (mm)	Suction & Discharge Conn. Size		Max. Capacity		Max. Head		Max. Impeller OD Size ³		Max. Power		Max. Weight	
		DN (mm)	NPS (inch)	(m ³ /hr)	(GPM)	(m)	(ft)	(mm)	(inch)	(kW)	(HP)	(kg)	(lb)
WES-1200	300 x 300 x 480	300	12	900	3,963	31	102	480	19	75	101	1,350	2,976
WES-1400	350 x 350 x 600	350	14	1,400	6,164	53	174	600	24	250	335	2,750	6,063
WES-1600	400 x 400 x 600	400	16	2,400	10,567	53	174	600	24	355	476	3,420	7,540

NOTES:

1. Please contact the factory for proper model selection for your application.
2. This is a general overview of the performance for this series of Turbo-Flow pumps.
3. Optional impeller sizes are available, including trimmed impeller sizes. Contact factory for additional information.
4. Wastecorp. Pumps reserves the right to make revisions to its products, performance, dimensions and specifications, and related information, without notice.



Wastecorp Turbo Flow WES Series Horizontal End Suction Centrifugal Pumps Pump Dimensions Using 60 Hz Motors²

WES Series End Suction Pumps Pump Dimensions (Utilizing 60 Hz / 3600 RPM Motors)

WES SERIES MODELS	MAX. PUMP DIMENSIONS ¹ (inches)				MAX. INSTALLATION DIMENSIONS ² (inches)						IN-OUTLET FLANGE DIMENSIONS (inches)					MAX. VIBRATION-INSULATION PAD ³ (inches)
	L	H	E	F	a	h	L ₁	B	I	Mounting Holes (4) do (Φ)	NPS (Φ)	OD (Φ)	BC (Φ)	No. of Holes	Hole Size N-d (Φ)	H ₁
WES-100	17.9	13.0	13.8	7.9	3.3	7.5	10.2	6.5	0.0	31/64	1.00	4.5	3.3	4	9/16	8.3
WES-125	20.3	16.7	16.1	9.8	3.5	10.0	10.2	8.5	0.7	9/16	1.25	5.5	3.9	4	3/4	10.8
WES-150	28.9	20.1	22.4	13.0	3.7	11.6	15.7	11.6	0.8	23/32	1.50	5.9	4.3	4	3/4	12.4
WES-200	36.2	23.4	27.6	15.6	4.1	12.8	19.7	13.8	0.4	23/32	2.00	6.5	4.9	4	3/4	13.6
WES-250	40.0	26.0	27.6	17.3	5.3	12.8	21.3	15.7	1.2	23/32	2.50	7.3	5.7	4	3/4	13.6
WES-300	45.1	28.5	35.4	21.7	5.3	16.9	26.0	20.1	1.2	7/8	3.00	7.9	6.3	8	3/4	18.6
WES-400	47.4	29.9	37.4	22.0	5.1	16.9	28.3	20.5	1.2	7/8	4.00	8.7	7.1	8	3/4	18.4
WES-500	47.4	29.9	35.0	21.7	6.1	17.1	28.3	20.1	1.2	7/8	5.00	9.8	8.3	8	3/4	18.6
WES-600	56.0	34.1	40.6	25.6	6.1	18.1	29.9	23.8	1.5	7/8	6.00	11.2	9.4	8	29/32	19.8
WES-800	61.9	41.9	46.1	25.2	7.3	20.7	29.9	24.0	0.8	7/8	8.00	13.4	11.6	12	29/32	22.4
WES-1000	63.3	45.9	45.5	26.0	8.9	22.2	33.9	24.4	1.3	7/8	10.00	15.9	13.2	12	1-7/64	23.9
WES-1200	75.4	49.2	59.1	34.6	11.8	23.6	47.2	33.1	1.0	1-1/32	12.00	18.1	16.1	12	1-7/64	25.3
WES-1400	82.7	61.0	56.7	44.1	12.6	29.1	44.3	41.7	1.2	1-1/32	14.00	20.5	18.5	16	1-7/64	30.2
WES-1600	89.2	65.0	70.9	38.6	11.8	31.5	58.3	33.9	-2.4	1-25/64	16.00	22.8	20.7	16	1-15/64	35.0
WES-2000	70.5	51.6	50.8	32.3	15.0	22.8	35.4	30.3	0.0	1-1/32	20.00	28.1	25.6	16	1-15/64	24.5

WES Series End Suction Pumps Pump Dimensions (Utilizing 60 Hz / 1800 RPM Motors)

WES SERIES MODELS	MAX. PUMP DIMENSIONS ¹ (inches)				MAX. INSTALLATION DIMENSIONS ² (inches)						IN-OUTLET FLANGE DIMENSIONS (inches)					MAX. VIBRATION-INSULATION PAD ³ (inches)
	L	H	E	F	a	h	L ₁	B	I	Mounting Holes (4) do (Φ)	NPS (Φ)	OD (Φ)	BC (Φ)	No. of Holes N	Hole Size d (Φ)	H ₁
WES-150	20.1	20.1	15.7	13.0	3.7	11.6	10.2	11.6	1.0	23/32	1.50	5.9	4.3	4	3/4	12.4
WES-200	22.2	23.0	17.3	14.0	4.1	12.4	11.0	12.6	1.0	23/32	2.00	6.5	4.9	4	3/4	13.2
WES-250	26.5	26.0	18.5	14.2	5.4	14.6	11.8	12.6	0.9	23/32	2.50	7.3	5.7	4	3/4	15.4
WES-300	30.7	27.4	23.6	15.7	5.4	14.6	14.2	14.2	1.2	23/32	3.00	7.9	6.3	8	3/4	16.3
WES-400	32.8	28.5	25.6	15.9	5.9	15.6	16.5	14.4	1.2	7/8	4.00	8.7	7.1	8	3/4	17.2
WES-500	32.8	28.5	25.6	15.9	5.9	15.6	16.5	14.4	1.2	7/8	5.00	9.8	8.3	8	3/4	17.2
WES-600	33.0	31.5	26.0	20.1	5.7	16.7	17.3	18.5	0.8	7/8	6.00	11.2	9.4	8	29/32	18.4

Notes:

- 1 Pump dimensions vary depending on impeller size. Contact factory for actual dimensions for your pump.
- 2 Installation dimensions vary depending on impeller and motor size. Contact factory for actual dimensions for your pump.
- 3 Vibration pad dimensions vary depending on motor size. Contact factory for actual dimensions for your pump.



**Wastecorp Turbo Flow WES Series
Horizontal End Suction Centrifugal Pumps
Pump Dimensions Using 50 Hz Motors²**

WES Series End Suction Pumps Pump Dimensions (Utilizing 50 Hz / 2900 RPM Motors)

WES SERIES MODELS	MAX. PUMP DIMENSIONS ¹ (mm)				MAX. INSTALLATION DIMENSIONS ² (mm)						IN-OUTLET FLANGE DIMENSIONS (mm)					MAX. VIBRATION-INSULATION PAD ³ (mm)
	L	H	E	F	a	h	L ₁	B	I	Mounting Holes (4) do (Φ)	DN (Φ)	D (Φ)	D ₁ (Φ)	No. of Holes (N)	Hole Size d (Φ)	H ₁
WES-100	455	330	350	200	85	190	260	165	0	12	25	115	85	4	14	210
WES-125	516	425	410	250	90	255	260	215	17.5	14	32	140	100	4	19	275
WES-150	735	510	570	330	95	295	400	295	20	18	40	150	110	4	19	315
WES-200	919	595	700	395	105	325	500	350	10	18	50	165	125	4	19	345
WES-250	1015	660	700	440	135	325	540	400	30	18	65	185	145	4	19	345
WES-300	1145	725	900	550	135	430	660	510	30	22	80	200	160	8	19	473
WES-400	1205	760	950	560	130	430	720	520	30	22	100	220	180	8	19	468
WES-500	1203	760	890	550	155	435	720	510	30	22	125	250	210	8	19	473
WES-600	1422	865	1030	650	155	460	760	605	37.5	22	150	285	240	8	23	503
WES-800	1572	1065	1170	640	185	525	760	610	20	22	200	340	295	12	23	568
WES-1000	1607	1165	1155	660	225	565	860	620	32.5	22	250	405	335	12	28	608
WES-1200	1915	1250	1500	880	300	600	1200	840	25	26	300	460	410	12	28	643
WES-1400	2101	1550	1440	1120	320	740	1125	1060	30	26	350	520	470	16	28	766
WES-1600	2265	1650	1800	980	300	800	1480	860	-60	35	400	580	525	16	31	889
WES-2000	1790	1310	1290	820	380	580	900	770	0	26	500	715	650	16	31	623

WES Series End Suction Pumps Pump Dimensions (Utilizing 50 Hz / 1450 RPM Motors)

WES SERIES MODELS	MAX. PUMP DIMENSIONS ¹ (mm)				MAX. INSTALLATION DIMENSIONS ² (mm)						IN-OUTLET FLANGE DIMENSIONS (mm)					MAX. VIBRATION-INSULATION PAD ³ (mm)
	L	H	E	F	a	h	L ₁	B	I	Mounting Holes (4) do (Φ)	DN (Φ)	D (Φ)	D ₁ (Φ)	No. of Holes (N)	Hole Size d (Φ)	H ₁
WES-150	510	510	400	330	95	295	260	295	25	18	40	150	110	4	19	315
WES-200	564	585	440	355	105	315	280	320	25	18	50	165	125	4	19	335
WES-250	672	660	470	360	137	370	300	320	22.5	18	65	185	145	4	19	390
WES-300	780	695	600	400	137	370	360	360	30	18	80	200	160	8	19	413
WES-400	833	725	650	405	150	395	420	365	30	22	100	220	180	8	19	438
WES-500	833	725	650	405	150	395	420	365	30	22	125	250	210	8	19	438
WES-600	837	800	660	510	145	425	440	470	20	22	150	285	240	8	23	468

Notes:

- 1 Pump dimensions vary depending on impeller size. Contact factory for actual dimensions for your pump.
- 2 Installation dimensions vary depending on impeller and motor size. Contact factory for actual dimensions for your pump.
- 3 Vibration pad dimensions vary depending on motor size. Contact factory for actual dimensions for your pump.



WES Series End Suction Pumps Dimensional Drawing

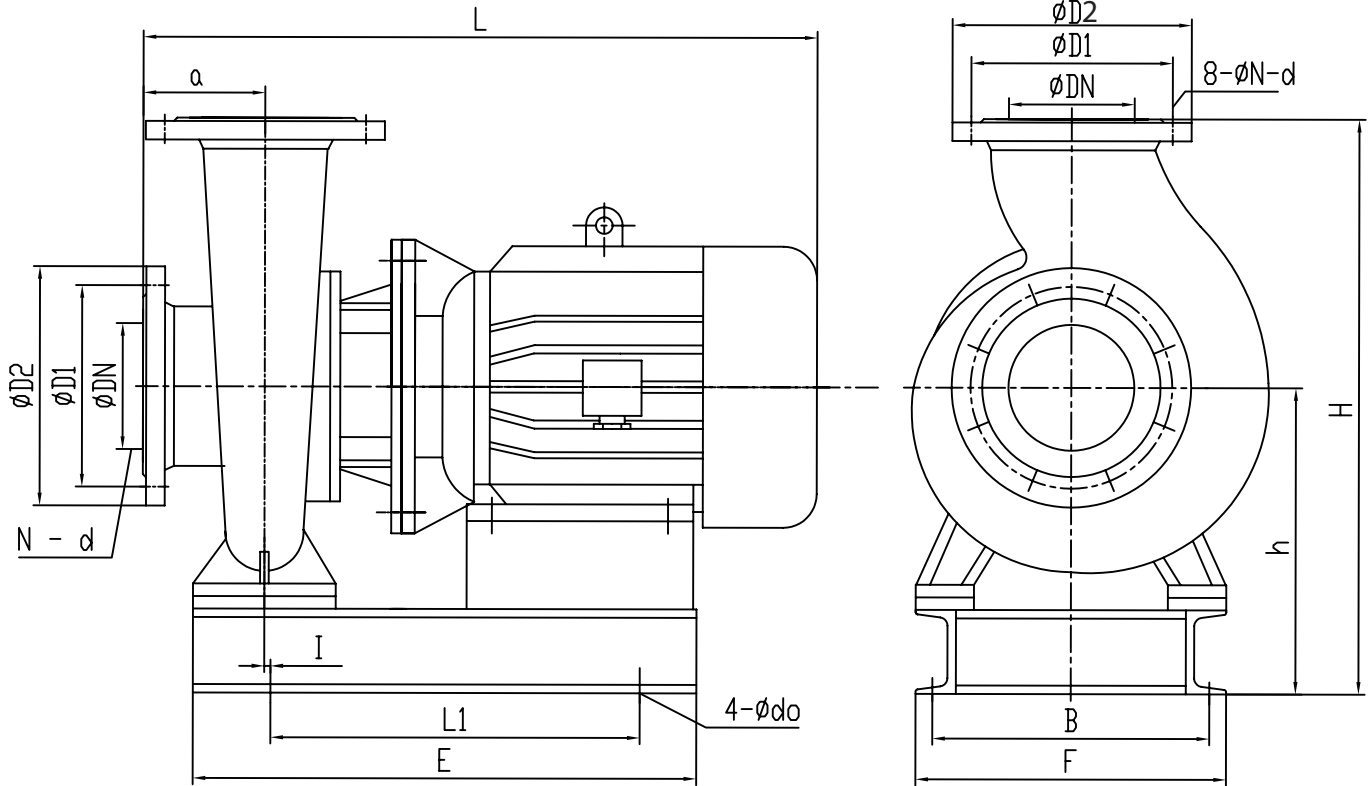

WES Series End Suction Pumps Cutaway Drawing

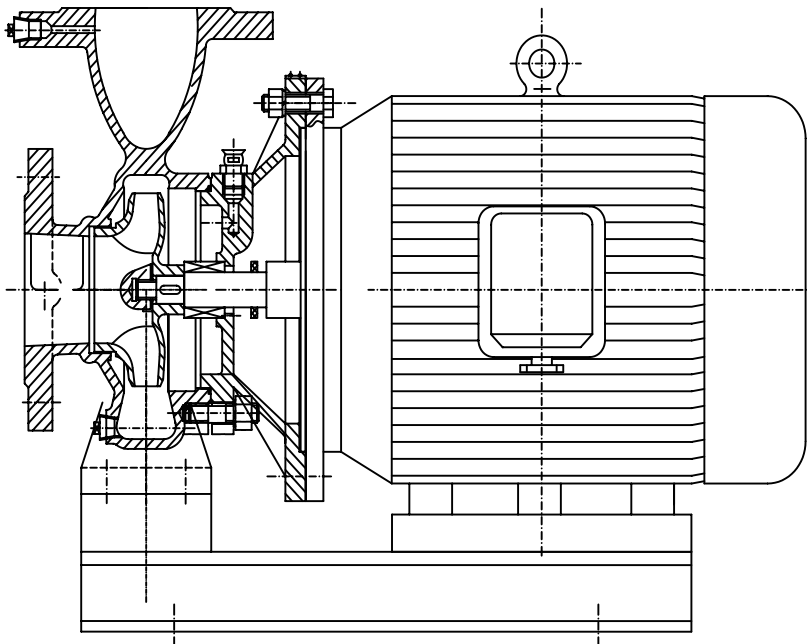

Refer to the WES Series dimensional chart for more information.



Wastecorp Turbo Flow WES Series End Suction Centrifugal Pumps Pump Curves Using 50 Hz Motors²

50 Hz @ 2950 RPM

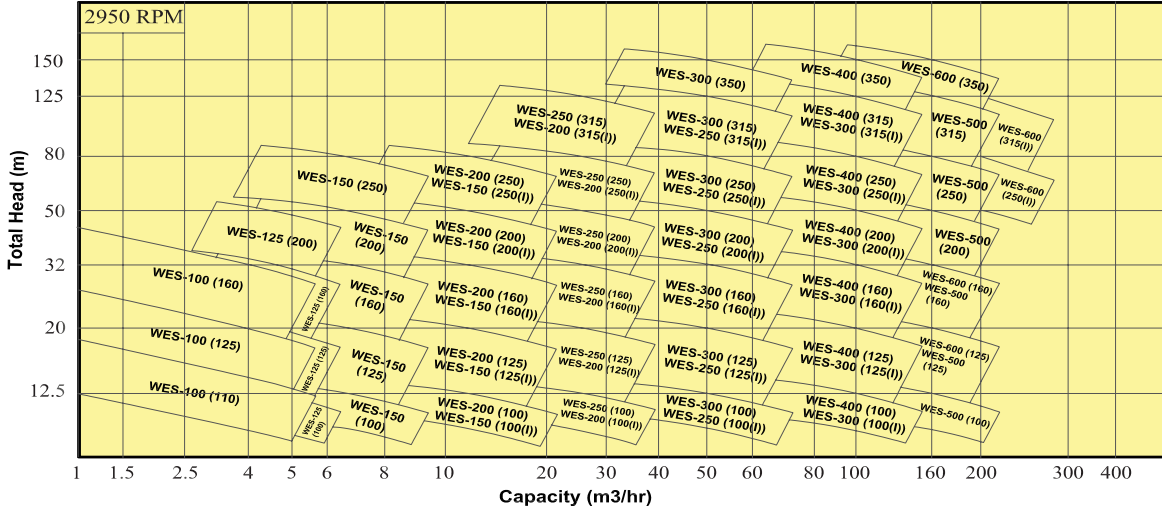

50 Hz @ 1480 RPM

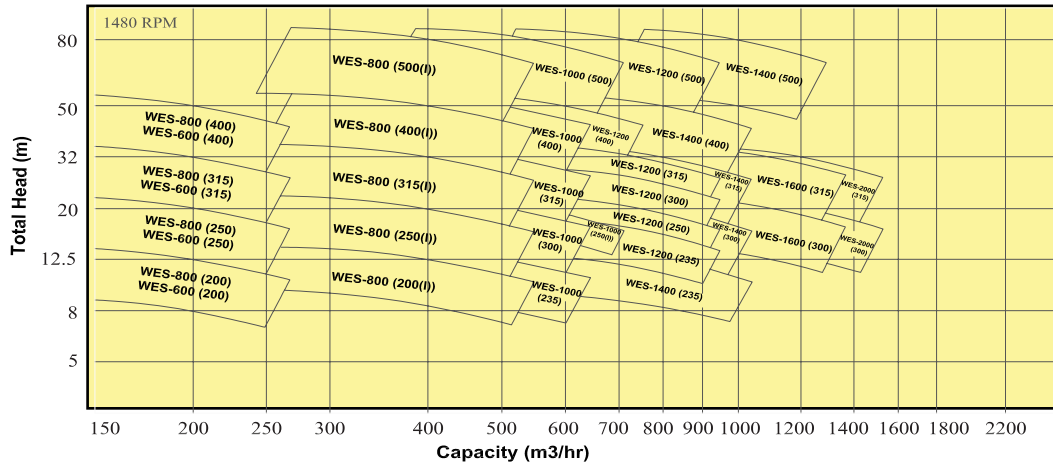

50 Hz @ 980 RPM

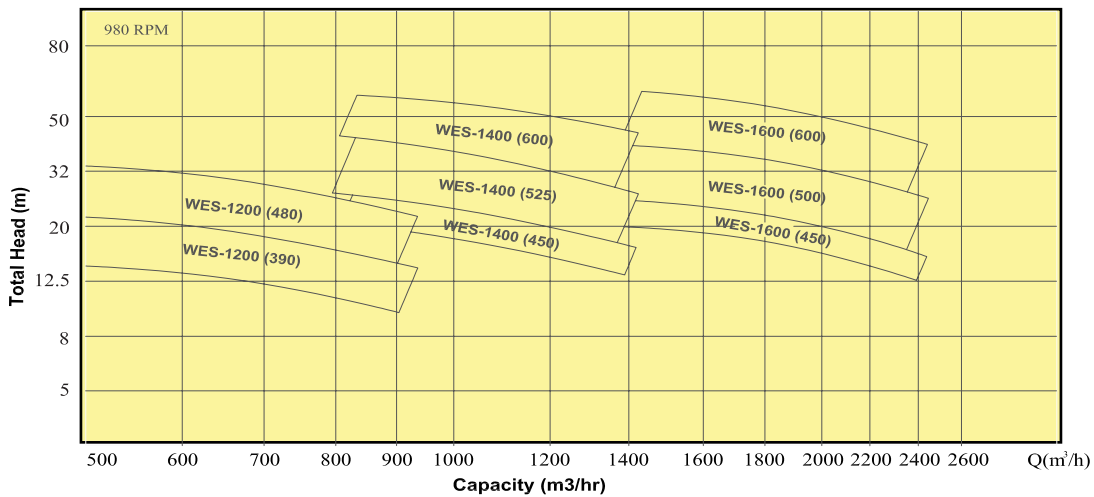



Wastecorp Turbo Flow WES Series End Suction Centrifugal Pumps Pump Curves Using 60 Hz Motors²

60 Hz @ 3600 RPM

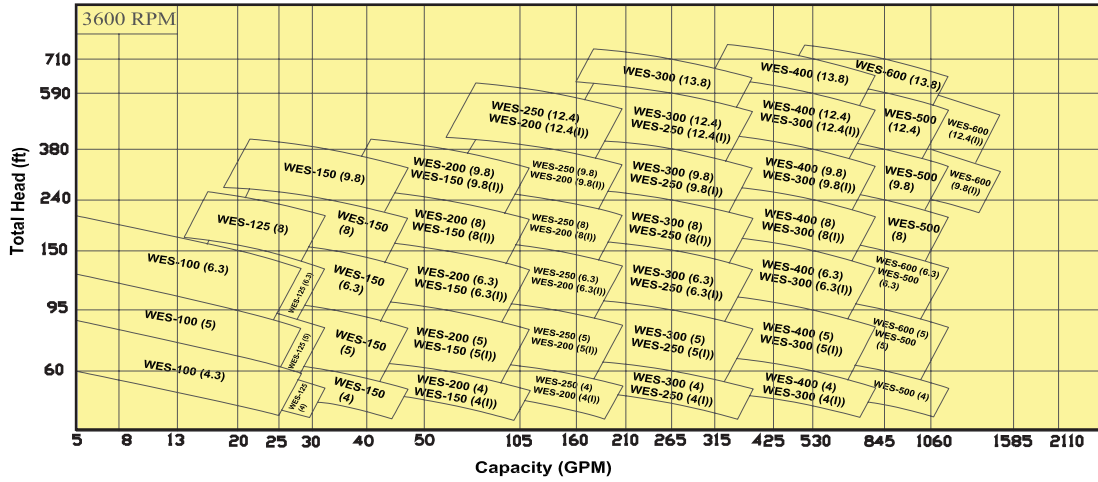

60 Hz @ 1750 RPM

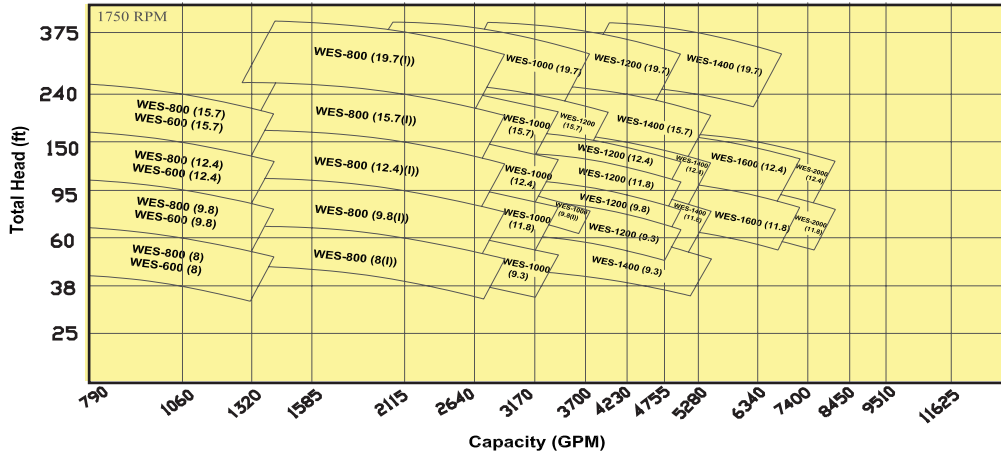

60 Hz @ 1200 RPM

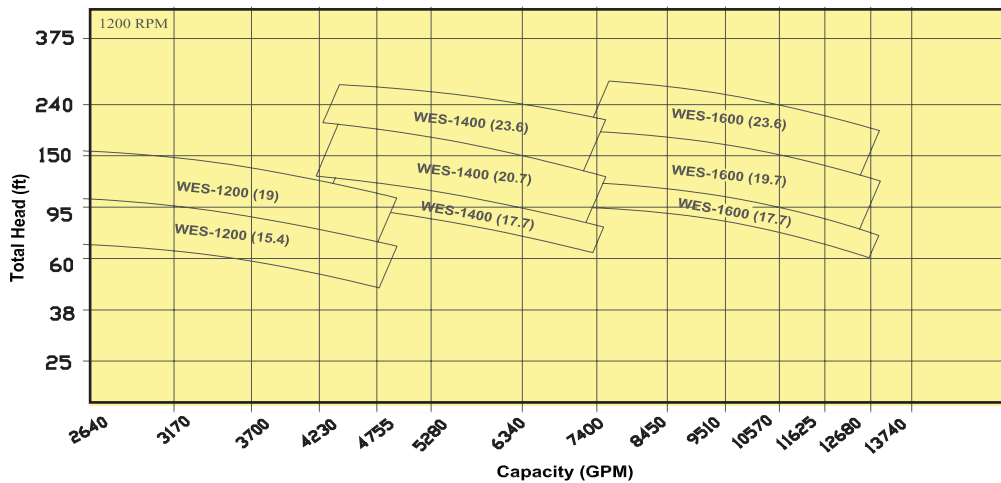



 **Turbo Flow**
A Wastecorp® Pump Brand

For more information contact **1.888.829.2783** or **info@wastecorp.com**
Visit us at **www.wastecorp.com**