

**Wastecorp Turbo Flow WSL Series
Vertical Non-Clog (Dry Pit) Sewage Pumps**

A Wastecorp® Pump Brand

WSL Series Vertical Sewage

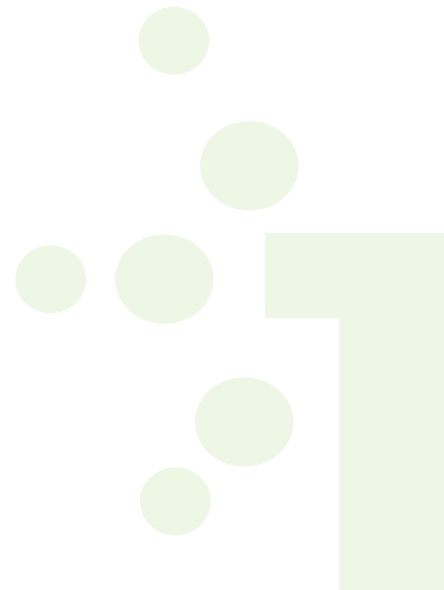



Vertical Sewage Pump Series

The WSL Series Turbo-Flow Dry Pit Vertical Sewage Pumps utilize the latest technology for a wide range of storm water, sewage, industrial wastes and dry dock applications. The WSL Series is available with vertical mounted motor configurations. Wastecorp's WSL Series are designed for long life, high efficiency, minimal downtime and lower maintenance costs than many other pump brands. These rugged heavy-duty cast iron pumps are engineered for easy maintenance, as the entire rotation element is removable without disturbing piping or the pump casing.

For horizontal motor mounting configurations, refer to Wastecorp's Turbo Flow **WES Series**.

Fluid Transfer

Any type of non-explosive liquids or slurry with maximum spherical solids handling up to 10" (250 mm), depending on model..

STANDARD FEATURES:

- Hydraulic balance design for steady characteristic curves
- Easy low cost maintenance and parts program
- High Efficiency, Mixed-Flow Impeller design
- Side-Discharge
- Flexible configurations, motor mounts (and connection orientation)
- Mechanical Seal Assembly
- Protective Shaft Sleeve

INDUSTRY USE AND APPLICATIONS:

Industry	Plumbing Application(s)
General Water Supply	Circulation water systems.
Agriculture/Food/Beverage	Irrigation, water supply, food processing, beverage processing, fertilizers, ash and dregs
Manufacturing	Pulp and paper fan pumps, paper mills, air wash, marine ballast service
Utilities: Water/Wastewater	Storm water, sewage and slurry
Chemical/Mining	Chemical plants, refineries, petroleum distribution, coal sites, methane pumping

SPECIFIC TECHNICAL DATA:

Technical Data	(50 Hz Motors)	(60 Hz Motors)
Max. Capacity	Up to 11,000 m ³ /hr	Up to 12,680 GPM
Max. Head	Up to 60 m	Up to 750 ft
Max. Temperatures	Up to 80°C	Up to 175°F
Max. Connection Size	Up to 900 mm	Up to 36 inches
Max. Motor/Power	Up to 710 kW	Up to 1,000 HP



**Wastecorp Turbo Flow WSL Series
Vertical Non-Clog (Dry Pit) Sewage Pumps
WSL Series - Cutaway Drawing**

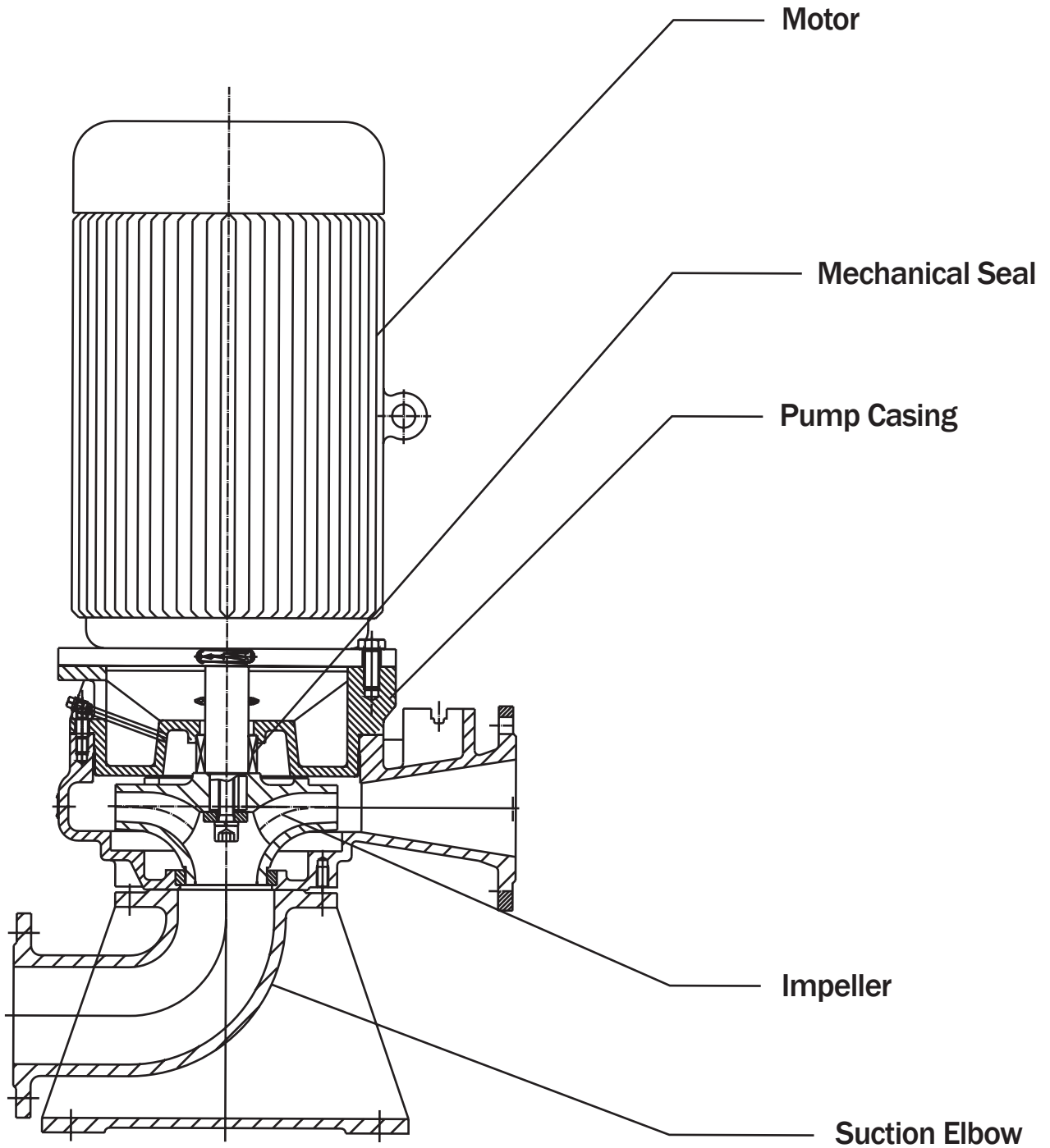



**Wastecorp Turbo Flow WSL Series
Vertical Non-Clog (Dry Pit) Sewage Pumps
Overview of Performance Range Using 60 Hz Motors²**

How to select your model:

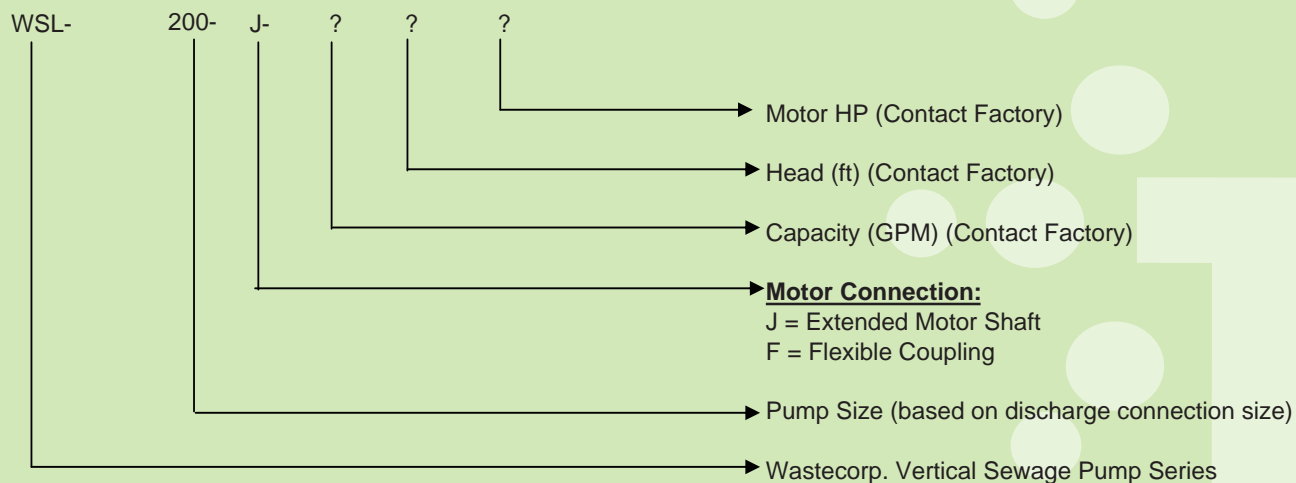

WSL Series Vertical Dry Pit Sewage Pumps Overview of Pump Performance (Speed 3600 RPM)

WSL SERIES MODELS	Discharge Connection Size		Suction Connection Size		Max. Capacity		Max. Head		Max. Power		Max. Weight	
	DN (mm)	NPS (inch)	DN (mm)	NPS (inch)	(m ³ /hr)	(GPM)	(m)	(ft)	(kW)	(HP)	(kg)	(lb)
WSL-200	50	2	50	2	30	132	43	142	7	9	65	143
WSL-300	80	3	80	3	60	264	58	189	26	35	205	452
WSL-400	100	4	100	4	96	423	58	189	38	51	290	639

WSL Series Vertical Dry Pit Sewage Pumps Overview of Pump Performance (Speed 1750 RPM)

WSL SERIES MODELS	Discharge Connection Size		Suction Connection Size		Max. Capacity		Max. Head		Max. Power		Max. Weight	
	DN (mm)	NPS (inch)	DN (mm)	NPS (inch)	(m ³ /hr)	(GPM)	(m)	(ft)	(kW)	(HP)	(kg)	(lb)
WSL-200	50	2	50	2	30	132	52	170	13	17	105	231
WSL-250	65	2.5	65	2.5	36	159	50	165	13	17	115	254
WSL-300	80	3	80	3	60	264	36	118	13	17	125	276
WSL-400	100	4	100	4	96	423	26	85	13	17	135	298
WSL-600	150	6	150	6	180	793	86	283	95	127	850	1,874
WSL-800	200	8	200	8	480	2,113	69	227	156	209	1,420	3,131
WSL-1000	250	10	250	10	720	3,170	72	236	228	306	1,710	3,770
WSL-1200	300	12	300	12	1,200	5,283	50	165	228	306	1,800	3,968
WSL-1400	350	14	400	16	1,320	5,812	52	170	276	371	2,700	5,952



Wastecorp Turbo Flow WSL Series Vertical Non-Clog (Dry Pit) Sewage Pumps Overview of Performance Range Using 60 Hz Motors²

WSL Series Vertical Dry Pit Sewage Pumps Overview of Pump Performance (Speed 1200 RPM)

WSL SERIES MODELS	Discharge Connection Size		Suction Connection Size		Max. Capacity		Max. Head		Max. Power		Max. Weight	
	DN (mm)	NPS (inch)	DN (mm)	NPS (inch)	(m ³ /hr)	(GPM)	(m)	(ft)	(kW)	(HP)	(kg)	(lb)
WSL-800	200	8	200	8	360	1,585	36	118	64	86	720	1,587
WSL-1000	250	10	250	10	600	2,642	36	118	95	127	1,115	2,458
WSL-1200	300	12	300	12	1,200	5,283	35	113	156	209	1,650	3,638
WSL-1400	350	14	400	16	1,320	5,812	29	94	156	209	1,770	3,902
WSL-1600	400	16	400	16	2,400	10,567	52	170	484	649	3,450	7,606
WSL-1800	450	18	450	18	2,640	11,624	22	71	228	306	2,070	4,564

WSL Series Vertical Dry Pit Sewage Pumps Overview of Pump Performance (Speed 900 RPM)

WSL SERIES MODELS	Discharge Connection Size		Suction Connection Size		Max. Capacity		Max. Head		Max. Power		Max. Weight	
	DN (mm)	NPS (inch)	DN (mm)	NPS (inch)	(m ³ /hr)	(GPM)	(m)	(ft)	(kW)	(HP)	(kg)	(lb)
WSL-1400	350	14	400	16	1,440	6,340	17	57	95	127	1,320	2,910
WSL-1600	400	16	400	16	1,800	7,925	14	47	95	127	1,470	3,241
WSL-2000	500	20	500	20	3,600	15,850	35	113	484	649	3,600	7,937
WSL-2400	600	24	600	24	4,800	21,134	29	94	544	730	4,000	8,818

WSL Series Vertical Dry Pit Sewage Pumps Overview of Pump Performance (Below 900 RPM)¹

WSL SERIES MODELS	Discharge Connection Size		Suction Connection Size		Max. Capacity		Max. Head		Max. Power		Max. Weight	
	DN (mm)	NPS (inch)	DN (mm)	NPS (inch)	(m ³ /hr)	(GPM)	(m)	(ft)	(kW)	(HP)	(kg)	(lb)
WSL-2400	600	24	600	24	3,600	15,850	10	33	228	306	3,000	6,614
WSL-2800	700	28	700	28	9,000	39,626	18	59	968	1,298	5,980	13,184
WSL-3200	800	32	900	36	14,400	63,401	15	49	1,227	1,645	7,100	15,653
WSL-3600	900	35	1000	40	13,200	58,118	6	20	544	730	6,200	13,669

NOTES:

1. For pumps operating at these speeds, contact factory for proper motor selection.
2. This is a general overview of the performance for this series of Turbo Flow pumps.
3. Wastecorp. Pumps reserves the right to make revisions to its products, performance, dimensions and specifications, and related information, without notice.
4. Please contact the factory for proper model selection for your application.



**Wastecorp Turbo Flow WSL Series
Vertical Non-Clog (Dry Pit) Sewage Pumps
Overview of Performance Range Using 50 Hz Motors²**

WSL Series Vertical Dry Pit Sewage Pumps Overview of Pump Performance (Speed 2900 RPM)

WSL SERIES MODELS	Discharge Connection Size		Suction Connection Size		Max. Capacity		Max. Head		Max. Power		Max. Weight	
	DN (mm)	NPS (inch)	DN (mm)	NPS (inch)	(m ³ /hr)	(GPM)	(m)	(ft)	(kW)	(HP)	(kg)	(lb)
WSL-200	50	2	50	2	25	110	30	98	4	5	65	143
WSL-300	80	3	80	3	50	220	40	131	15	20	205	452
WSL-400	100	4	100	4	80	352	40	131	22	30	290	639

WSL Series Vertical Dry Pit Sewage Pumps Overview of Pump Performance (Speed 1480 RPM)

WSL SERIES MODELS	Discharge Connection Size		Suction Connection Size		Max. Capacity		Max. Head		Max. Power		Max. Weight	
	DN (mm)	NPS (inch)	DN (mm)	NPS (inch)	(m ³ /hr)	(GPM)	(m)	(ft)	(kW)	(HP)	(kg)	(lb)
WSL-200	50	2	50	2	25	110	36	118	8	10	105	231
WSL-250	65	2.5	65	2.5	30	132	35	115	8	10	115	254
WSL-300	80	3	80	3	50	220	25	82	8	10	125	276
WSL-400	100	4	100	4	80	352	18	59	8	10	135	298
WSL-600	150	6	150	6	150	660	60	197	55	74	850	1,874
WSL-800	200	8	200	8	400	1,761	48	157	90	121	1,420	3,131
WSL-1000	250	10	250	10	600	2,642	50	164	132	177	1,710	3,770
WSL-1200	300	12	300	12	1,000	4,403	35	115	132	177	1,800	3,968
WSL-1400	350	14	400	16	1,100	4,843	36	118	160	215	2,700	5,952

WSL Series Vertical Dry Pit Sewage Pumps Overview of Pump Performance (Speed 980 RPM)¹

WSL SERIES MODELS	Discharge Connection Size		Suction Connection Size		Max. Capacity		Max. Head		Max. Power		Max. Weight	
	DN (mm)	NPS (inch)	DN (mm)	NPS (inch)	(m ³ /hr)	(GPM)	(m)	(ft)	(kW)	(HP)	(kg)	(lb)
WSL-800	200	8	200	8	300	1,321	25	82	37	50	720	1,587
WSL-1000	250	10	250	10	500	2,201	25	82	55	74	1,115	2,458
WSL-1200	300	12	300	12	1,000	4,403	24	79	90	121	1,650	3,638
WSL-1400	350	14	400	16	1,100	4,843	20	66	90	121	1,770	3,902
WSL-1600	400	16	400	16	2,000	8,806	36	118	280	375	3,450	7,606
WSL-1800	450	18	450	18	2,200	9,686	15	49	132	177	2,070	4,564

NOTES:

1. For pumps operating at these speeds, contact factory for proper motor selection.
2. This is a general overview of the performance for this series of Turbo Flow pumps.
3. Wastecorp. Pumps reserves the right to make revisions to its products, performance, dimensions and specifications, and related information, without notice.
4. Please contact the factory for proper model selection for your application.



Wastecorp Turbo Flow WSL Series Vertical Non-Clog (Dry Pit) Sewage Pumps Overview of Performance Range Using 50 Hz Motors²

WSL Series Vertical Dry Pit Sewage Pumps Overview of Pump Performance (Speed 740 RPM)

WSL SERIES MODELS	Discharge Connection Size		Suction Connection Size		Max. Capacity		Max. Head		Max. Power		Max. Weight	
	DN (mm)	NPS (inch)	DN (mm)	NPS (inch)	(m ³ /hr)	(GPM)	(m)	(ft)	(kW)	(HP)	(kg)	(lb)
WSL-1400	350	14	400	16	1,200	5,283	12	39	55	74	1,320	2,910
WSL-1600	400	16	400	16	1,500	6,604	10	33	55	74	1,470	3,241
WSL-2000	500	20	500	20	3,000	13,209	24	79	280	375	3,600	7,937
WSL-2400	600	24	600	24	4,000	17,611	20	66	315	422	4,000	8,818

WSL Series Vertical Dry Pit Sewage Pumps Pump Performance (Speed 420-590 RPM)¹

WSL SERIES MODELS	Discharge Connection Size		Suction Connection Size		Max. Capacity		Max. Head		Max. Power		Max. Weight	
	DN (mm)	NPS (inch)	DN (mm)	NPS (inch)	(m ³ /hr)	(GPM)	(m)	(ft)	(kW)	(HP)	(kg)	(lb)
WSL-2400	600	24	600	24	3,000	13,209	10	33	132	177	3,000	6,614
WSL-2800	700	28	700	28	7,500	33,021	18	59	560	751	5,980	13,184
WSL-3200	800	32	900	36	12,000	52,834	15	49	710	952	7,100	15,653
WSL-3600	900	35	1000	40	11,000	48,431	6	20	315	422	6,200	13,669

NOTES:

1. For pumps operating at these speeds, contact factory for proper motor selection.
2. This is a general overview of the performance for this series of Turbo-Flow pumps.
3. Wastecorp. Pumps reserves the right to make revisions to its products, performance, dimensions and specifications, and related information, without notice.
4. Please contact the factory for proper model selection for your application.



Turbo Flow WSL Compact Series (JP Style)

Suction Elbow Connection Style

Straight In Suction Connection Style

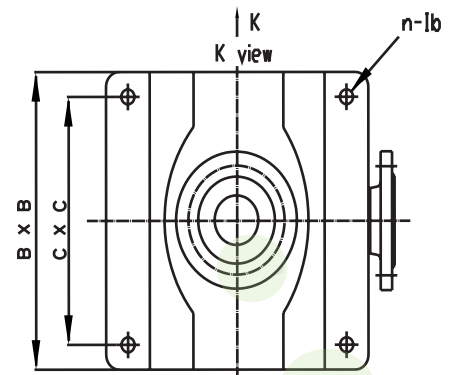
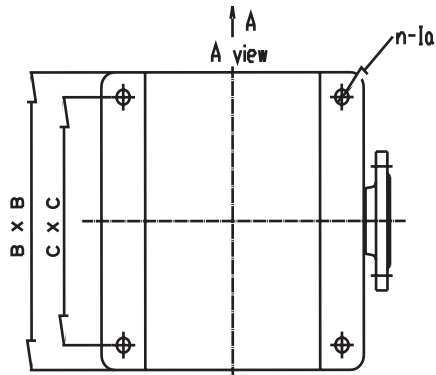
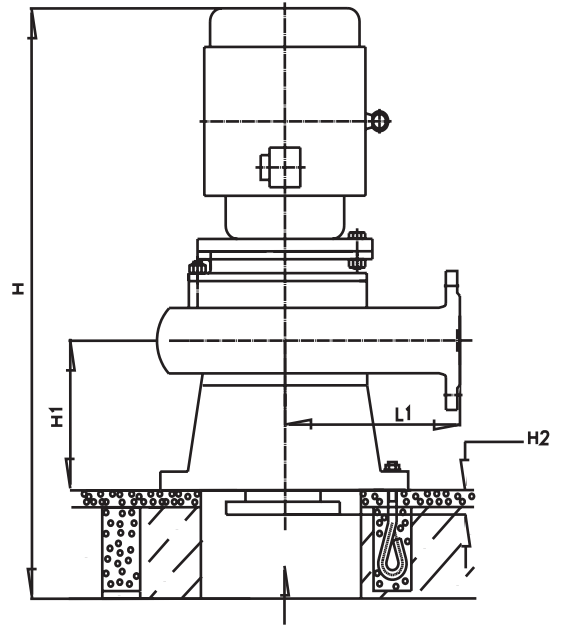
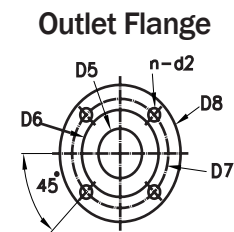
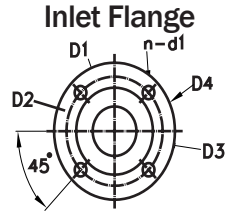
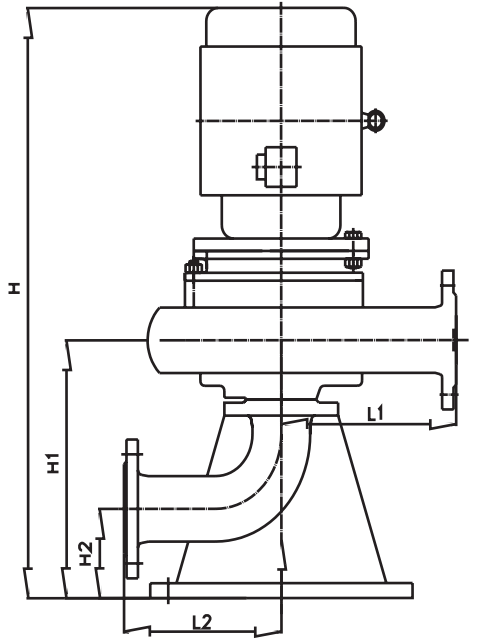



**Wastecorp Turbo Flow WSL Series
Vertical Non-Clog (Dry Pit) Sewage Pumps
General Pump Dimensions - Compact Series**

WSL Series Vertical Dry Pit Sewage Pumps General Pump Dimensions - JP Style - METRIC

WSL-(J) SERIES MODELS	Suction Flange (mm)						Discharge Flange (mm)						MAX.	Max. Suction Elbow Connection (mm)								Max. Straight-in Suction Connection (mm)											
	D1	D2	D3	D4	n	Φd1	D5	D6	D7	D8	n-	Φd2		L1	H1	H2	H	L2	C x C	B x B	n-	Φa	D x D	E x E	n-	Φb	H1	H2	H	J			
METRIC																																	
WSL-200(J)	50	90	110	140	4	13.5	50	90	110	140	4	13.5	280	280	90	860	180	250	250	300	300	4	15	250	250	300	300	4	15	135	40	730	100
WSL-250(J)	65	110	130	160	4	13.5	65	110	130	160	4	13.5	280	280	100	860	180	265	265	305	305	4	15	265	265	305	305	4	15	140	40	720	120
WSL-300(J)	80	128	150	190	4	17.5	80	128	150	190	4	17.5	300	355	110	985	220	320	320	380	380	4	20	320	320	380	380	4	20	190	55	820	150
WSL-400(J)	100	148	170	210	4	17.5	100	148	170	210	4	17.5	320	335	120	1040	220	320	320	380	380	4	20	320	320	380	380	4	20	185	50	870	180
WSL-600(J)	150	202	225	265	8	17.5	150	202	225	265	8	17.5	450	475	160	1495	270	400	400	480	480	4	20	400	400	480	480	4	20	255	60	1275	200
WSL-800(J)	200	258	280	320	8	17.5	200	258	280	320	8	17.5	500	595	200	1905	350	520	520	600	600	4	25	580	580	680	680	4	25	315	80	1625	280
WSL-1000(J)	250	312	335	375	12	17.5	250	312	335	375	12	17.5	550	620	225	2300	350	520	520	600	600	4	25	580	580	680	680	4	25	320	100	2000	330
WSL-1200(J)	300	365	395	440	12	22	300	365	395	440	12	22	550	620	225	2300	350	520	520	600	600	4	25	680	680	760	760	4	25	320	100	2000	400

For pumps larger than 150 mm connections, see also Pump Dimensions for Coupled Motors

WSL Series Vertical Dry Pit Sewage Pumps General Pump Dimensions - JP Style - Imperial

WSL-(J) SERIES MODELS	Suction Flange (inches)						Discharge Flange (inches)						MAX.	Max. Suction Elbow Connection (inches)								Max. Straight-in Suction Connection (inches)											
	D1	D2	D3	D4	n	Φd1	D5	D6	D7	D8	n-	Φd2		L1	H1	H2	H	L2	C x C	B x B	n-	Φa	D x D	E x E	n-	Φb	H1	H2	H	J			
IMPERIAL																																	
WSL-200(J)	2	4	4	6	4	17/32	2	4	4	6	4	17/32	11	11	4	34	7	10	10	12	12	4	9/16	10	10	12	12	4	9/16	5	2	29	4
WSL-250(J)	3	4	5	6	4	17/32	3	4	5	6	4	17/32	11	11	4	34	7	10	10	12	12	4	9/16	10	10	12	12	4	9/16	6	2	28	5
WSL-300(J)	3	5	6	7	4	11/16	3	5	6	7	4	11/16	12	14	4	39	9	13	13	15	15	4	13/16	13	13	15	15	4	13/16	7	2	32	6
WSL-400(J)	4	6	7	8	4	11/16	4	6	7	8	4	11/16	13	13	5	41	9	13	13	15	15	4	13/16	13	13	15	15	4	13/16	7	2	34	7
WSL-600(J)	6	8	9	10	8	11/16	6	8	9	10	8	11/16	18	19	6	59	11	16	16	19	19	4	13/16	16	16	19	19	4	13/16	10	2	50	8
WSL-800(J)	8	10	11	13	8	11/16	8	10	11	13	8	11/16	20	23	8	75	14	20	20	24	24	4	31/32	23	23	27	27	4	31/32	12	3	64	11
WSL-1000(J)	10	12	13	15	12	11/16	10	12	13	15	12	11/16	22	24	9	91	14	20	20	24	24	4	31/32	23	23	27	27	4	31/32	13	4	79	13
WSL-1200(J)	12	14	16	17	12	7/8	12	14	16	17	12	7/8	22	24	9	91	14	20	20	24	24	4	31/32	27	27	30	30	4	31/32	13	4	79	16

For pumps larger than 6" connections, see also Pump Dimensions for Coupled Motors

Notes:

- ¹ Pump dimensions vary depending on pump model. Contact factory for actual dimensions for your pump.
- ² Installation dimensions vary depending on installation configuration. Contact factory for actual dimensions for your pump.



Turbo Flow WSL Flex Coupling Series

Suction Elbow Connection Style Straight In Suction Connection Style

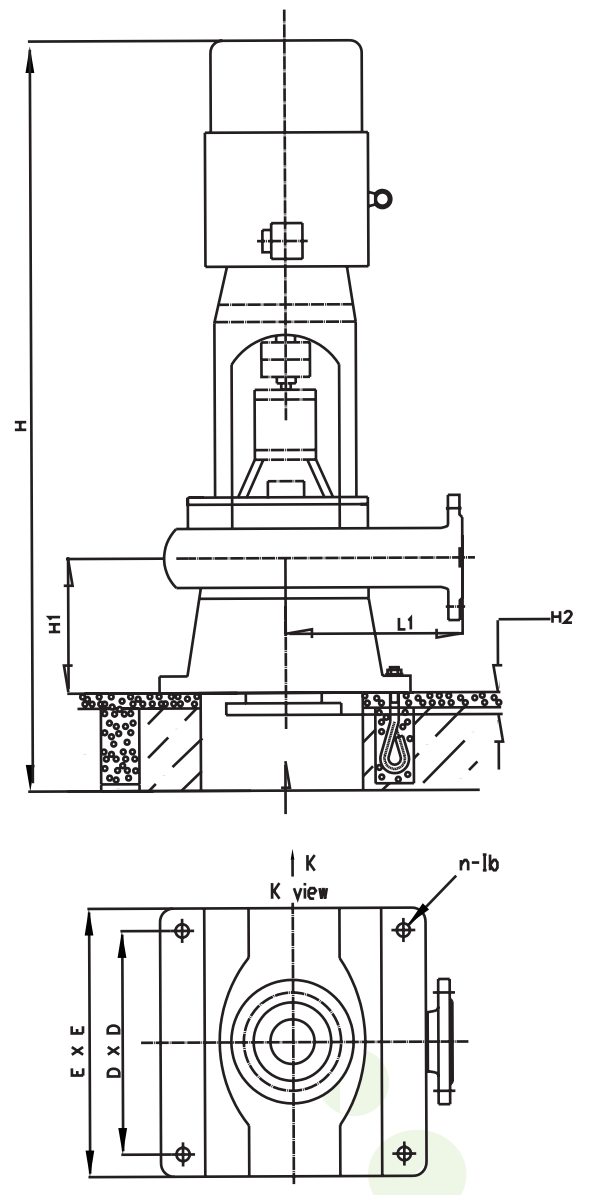
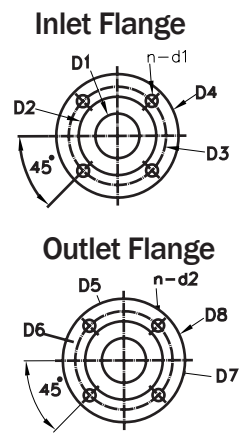
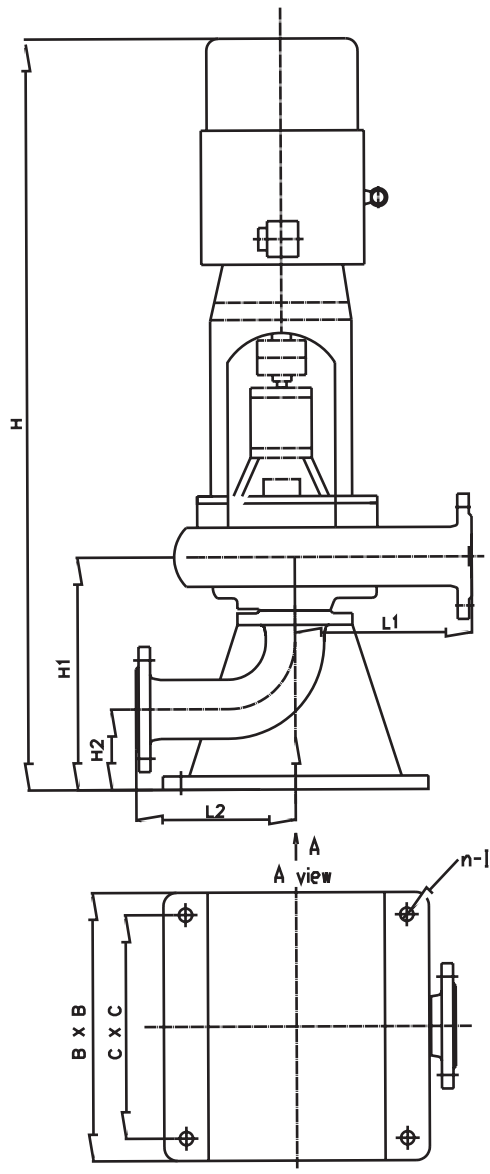



Wastecorp Turbo Flow WSL Series Vertical Non-Clog (Dry Pit) Sewage Pumps General Pump Dimensions - Flexible Coupling Series

WSL Series Vertical Dry Pit Sewage Pumps General Pump Dimensions - Flexible Coupling - Metric

WSL-(F) SERIES MODELS	Suction Flange (mm)						Discharge Flange (mm)						MAX.	Max. Suction Elbow Connection (mm)								Max. Straight-in Suction Connection (mm)											
	D1	D2	D3	D4	n	Φd1	D5	D6	D7	D8	n-	Φd2		L1	H1	H2	H	L2	C x C	B x B	n-	Φa	D x D	E x E	n-	Φb	H1	H2	H	J			
METRIC																																	
WSL-800(F)	200	258	280	320	8	17.5	200	258	280	320	8	17.5	500	595	200	3005	350	520	520	600	600	4	25	580	580	680	680	4	25	315	80	2725	280
WSL-1000(F)	250	312	335	375	12	17.5	250	315	335	375	12	17.5	550	620	225	3400	350	520	520	600	600	4	25	580	580	680	680	4	25	320	100	3100	330
WSL-1200(F)	300	365	395	440	12	22	300	365	395	440	12	22	550	620	225	3400	350	520	520	600	600	4	25	680	680	760	760	4	25	320	100	3100	400
WSL-1400(F)	400	482	515	565	16	26	350	415	445	490	12	22	600	1005	330	3655	600	1000	1000	1100	1100	4	50	1000	1000	1100	1100	4	50	620	~	3355	480
WSL-1600(F)	400	482	515	565	16	26	400	482	515	565	16	26	650	1040	330	4275	600	1000	1000	1100	1100	4	50	1000	1000	1100	1100	4	50	650	~	3975	480
WSL-1800(F)	450	532	565	615	20	26	450	532	565	615	20	26	700	1175	550	3785	600	1000	1000	1100	1100	4	50	1000	1000	1100	1100	4	50	695	~	3485	550
WSL-2000(F)	500	585	620	670	20	26	500	585	620	670	20	26	1000	1375	450	4855	700	1100	1100	1200	1200	4	50	1100	1100	1200	1200	4	50	830	~	4315	600
WSL-2400(F)	600	685	725	785	20	30	600	685	725	785	20	30	1000	1375	450	4855	700	1100	1100	1200	1200	4	50	1100	1100	1200	1200	4	50	830	~	4315	700

For pumps larger than 600 mm connections, contact factory.

WSL Series Vertical Dry Pit Sewage Pumps General Pump Dimensions - Flexible Coupling - Imperial

WSL-(F) SERIES MODELS	Suction Flange (inches)						Discharge Flange (inches)						MAX.	Max. Suction Elbow Connection (inches)								Max. Straight-in Suction Connection (inches)											
	D1	D2	D3	D4	n	Φd1	D5	D6	D7	D8	n-	Φd2		L1	H1	H2	H	L2	C x C	B x B	n-	Φa	D x D	E x E	n-	Φb	H1	H2	H	J			
IMPERIAL																																	
WSL-800(F)	8	10	11	13	8	11/16	8	10	11	13	8	11/16	20	23	8	118	14	20	20	24	24	4	31/32	23	23	27	27	4	31/32	12	3	107	11
WSL-1000(F)	10	12	13	15	12	11/16	10	12	13	15	12	11/16	22	24	9	134	14	20	20	24	24	4	31/32	23	23	27	27	4	31/32	13	4	122	13
WSL-1200(F)	12	14	16	17	12	7/8	12	14	16	17	12	7/8	22	24	9	134	14	20	20	24	24	4	31/32	27	27	30	30	4	31/32	13	4	122	16
WSL-1400(F)	16	19	20	22	16	1 1/32	14	16	18	19	12	7/8	24	40	13	144	24	39	39	43	43	4	1 15/16	39	39	43	43	4	1 15/16	24	~	132	19
WSL-1600(F)	16	19	20	22	16	1 1/32	16	19	20	22	16	1 1/32	26	41	13	168	24	39	39	43	43	4	1 15/16	39	39	43	43	4	1 15/16	26	~	156	19
WSL-1800(F)	18	21	22	24	20	1 1/32	18	21	22	24	20	1 1/32	28	46	22	149	24	39	39	43	43	4	1 15/16	39	39	43	43	4	1 15/16	27	~	137	22
WSL-2000(F)	20	23	24	26	20	1 1/32	20	23	24	26	20	1 1/32	39	54	18	191	28	43	43	47	47	4	1 15/16	43	43	47	47	4	1 15/16	33	~	170	24
WSL-2400(F)	24	27	29	31	20	1 3/16	24	27	29	31	20	1 3/16	39	54	18	191	28	43	43	47	47	4	1 15/16	43	43	47	47	4	1 15/16	33	~	170	28

For pumps larger than 24" connections, contact factory.

Notes:

¹ Pump dimensions vary depending on pump model. Contact factory for actual dimensions for your pump.

² Installation dimensions vary depending on installation configuration. Contact factory for actual dimensions for your pump.



 **Turbo Flow**
A Wastecorp® Pump Brand

For more information contact **1.888.829.2783** or info@wastecorp.com
Visit us at www.wastecorp.com